



Notes:

1. Source information: GEN_PD-ACM-HML-DGT_ZZ_ZZ_ZZ-DR-T-0011 P04 and GEN_PD-ACM-HML-DGT_ZZ_ZZ_ZZ-DR-T-0012 P04
2. Indicative Construction Phasing Sheets 11 & 12 Drawing Refs GEN_PD-ACM-PLS-DGT_ZZ_ZZ_ZZ-DR-T-011 P03 and GEN_PD-ACM-PLS-DGT_ZZ_ZZ_ZZ-DR-T-012 P02



Datom Engineering Ltd

B4016 – CONSTRUCTION METHOD OPTIONS

Legend:

Originator: RH

Date of Issue:
18/03/26

B4016 & Sutton Courtenay Roundabout/HIF1
Context Drawing 1

R3.0138/21-OP-DATOM-001

P01



Notes:

- 1.



Datom Engineering Ltd

B4016 – CONSTRUCTION
METHOD OPTIONS

Legend:

- Road Open to Traffic
- Road Under Construction
- Road Complete but not open to Traffic

Originator: RH

Date of Issue:
18/03/26

B4016 & Suttton Courtenay Roundabout/HIF1
Context Drawing 2

R3.0138/21-OP-DATOM-002

P01

Notes:

1.

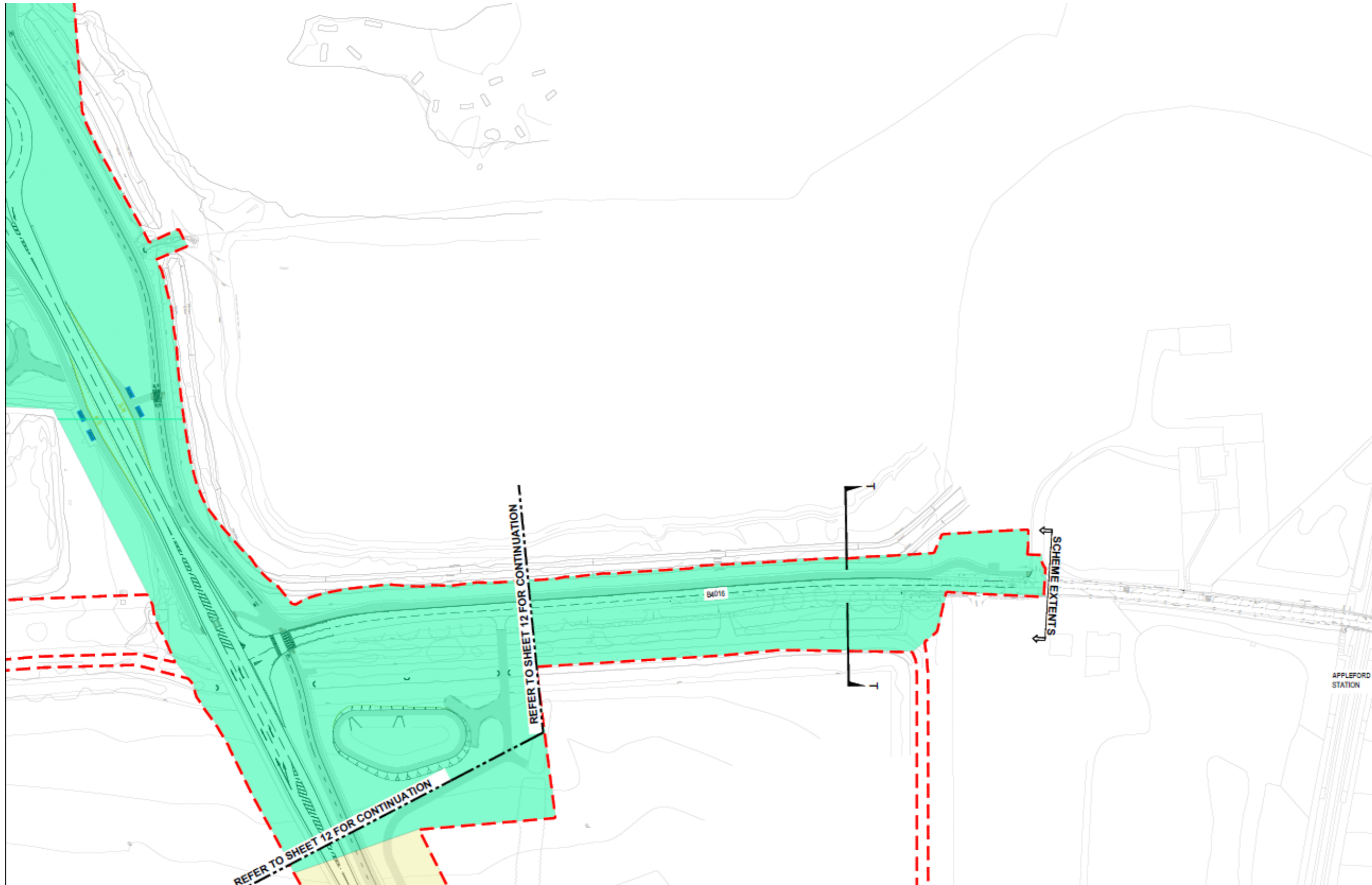

Datom Engineering Ltd

B4016 – CONSTRUCTION
METHOD OPTIONS

Legend:

-  Road Open to Traffic
-  Road Under Construction
-  Road Complete but not open to Traffic

Originator: RH

Date of Issue:
18/03/26

B4016 & Sutton Courtenay Roundabout/HIF1
Context Drawing 3

R3.0138/21-OP-DATOM-003

P01

OPTION 1

OPTION 1

- FULL B4016 ROAD CLOSURE 2026 - 2028

RISK

- HIGH RISK OF COMMUNITY DISENGAGEMENT
- HIGH IMPACT ON SCHOOLS
- HIGH IMPACT ON RESIDENTS
- HIGH RISK IMPACT IF TRAFFIC MODELLING IS INCORRECT
- HIGH RISK IMPACT DUE TO ANY A34 INCIDENT
- LOW CONSTRUCTION RISKS
- CHEAPEST OPTION FOR CLIENT
- ZERO CLIENT QUDOS

Notes:

1.

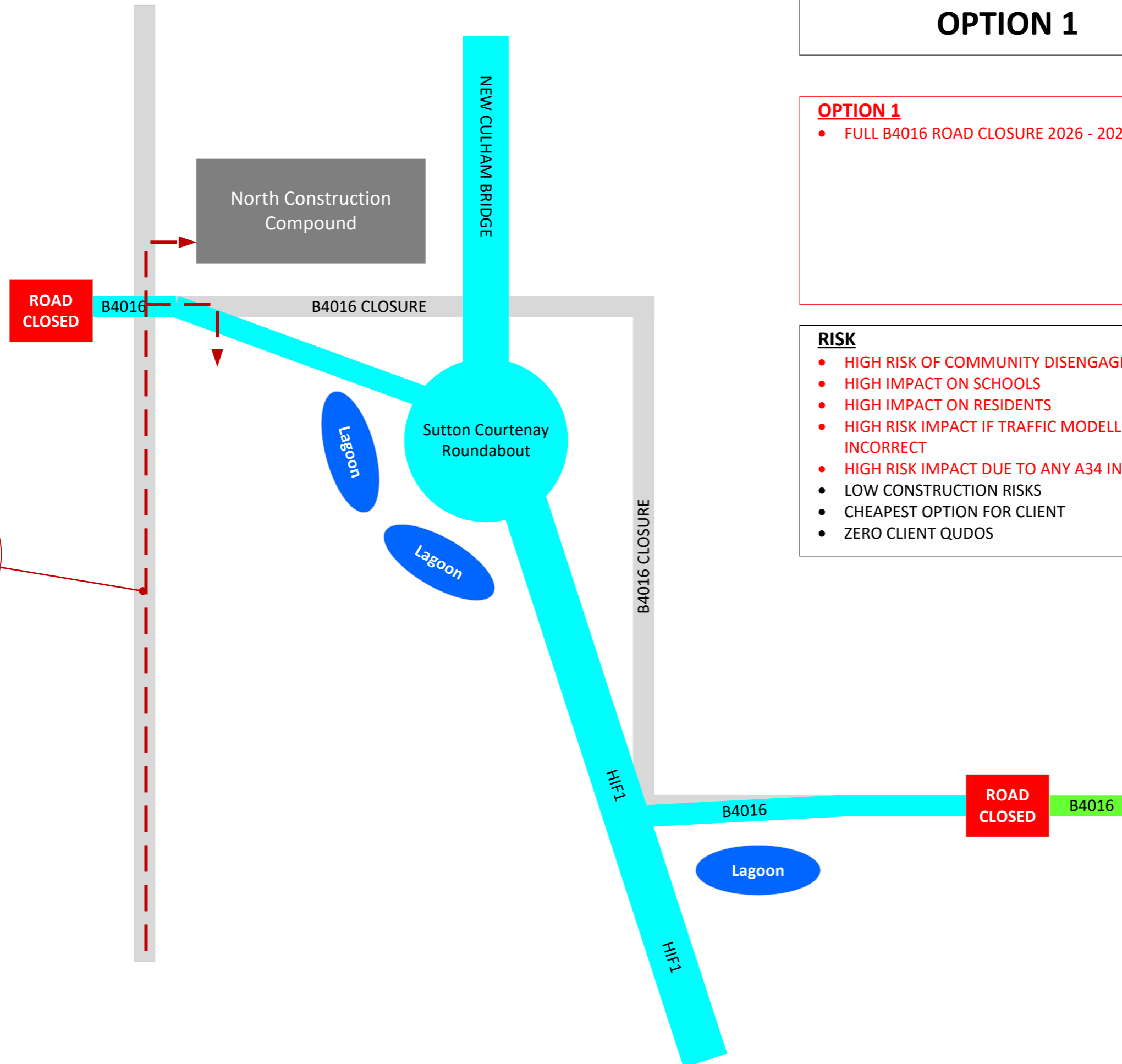

Construction Traffic Movements via Hanson Way



Datom Engineering Ltd

B4016 – CONSTRUCTION METHOD OPTIONS

Legend:

- Road Open to Traffic
- Road Under Construction
- Road Complete but not open to Traffic

Originator: RH

Date of Issue:
18/03/26

OPTION 1
FULL B4016 ROAD CLOSURE FOR PROJECT DURATION

R3.0138/21-OP-DATOM-004

P01

Traffic Signals to assist Construction Traffic Movements. Traffic Signals to be in place for the duration of the works

Culham Bridge Under Construction

OPTION 2

OPTION 2A – 6 WEEK SUMMER 2027 CLOSURE
 B4016 ROAD CLOSED FROM START OF SUMMER SCHOOL HOLIDAY (CIRCA 19th JULY 2027 – 30th AUGUST 2027 FOR 6 WEEKS TO ALLOW THE CONTRACTOR TO UNDERTAKE THE FULL MIGRATION SCHEME WITH THE NEW ROAD BECOMING OPERATIONAL SEPTEMBER 2027 READY FOR THE NEW SCHOOL AUTUMN TERM.

Notes:
1.

Construction Traffic Movements via Hanson Way

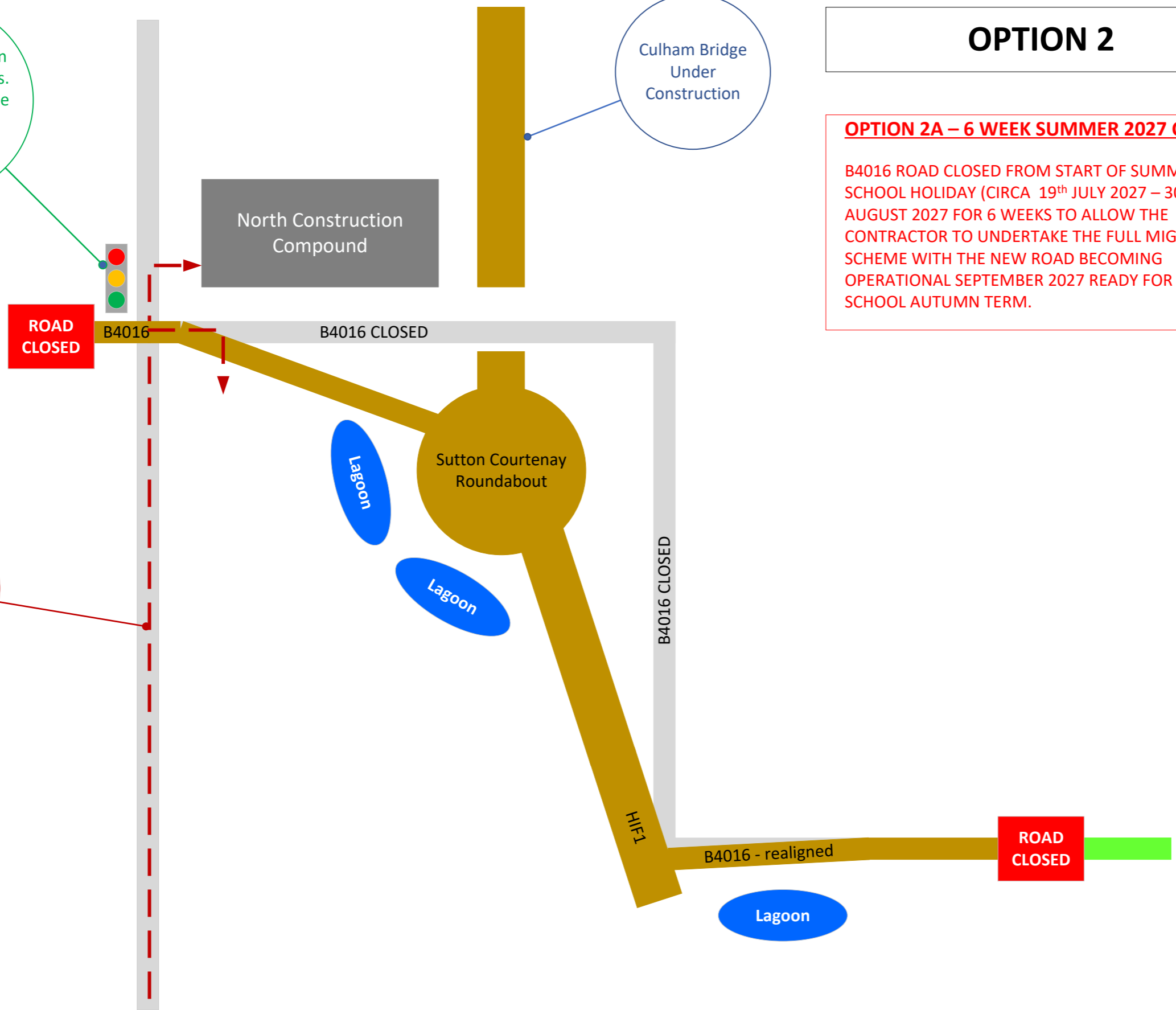

Legend:
 Road Open to Traffic
 Road Under Construction
 Road Complete but not open to Traffic

Originator: RH

Date of Issue: 18/03/26

OPTION 2A
B4016 CLOSURES FOR 6 WEEKS SUMMER 2027

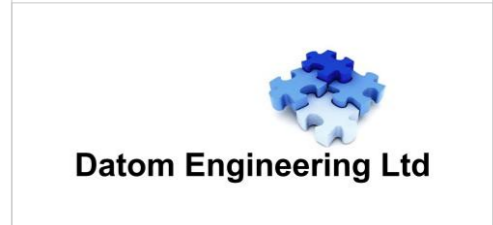

B4016 – CONSTRUCTION METHOD OPTIONS

Traffic Signals to assist Construction Traffic Movements. Traffic Signals to be in place for the duration of the works

Culham Bridge Under Construction

OPTION 3

OPTION 3A - B4016 2026 SUMMER CLOSURE
20th July 2026 – 1st September 2026

- Construct Sutton Courtenay Temp Loop
- Realignment of HIF1 – Appleford B4016 Interchange

Notes:
1.

Construction Traffic Movements via Hanson Way

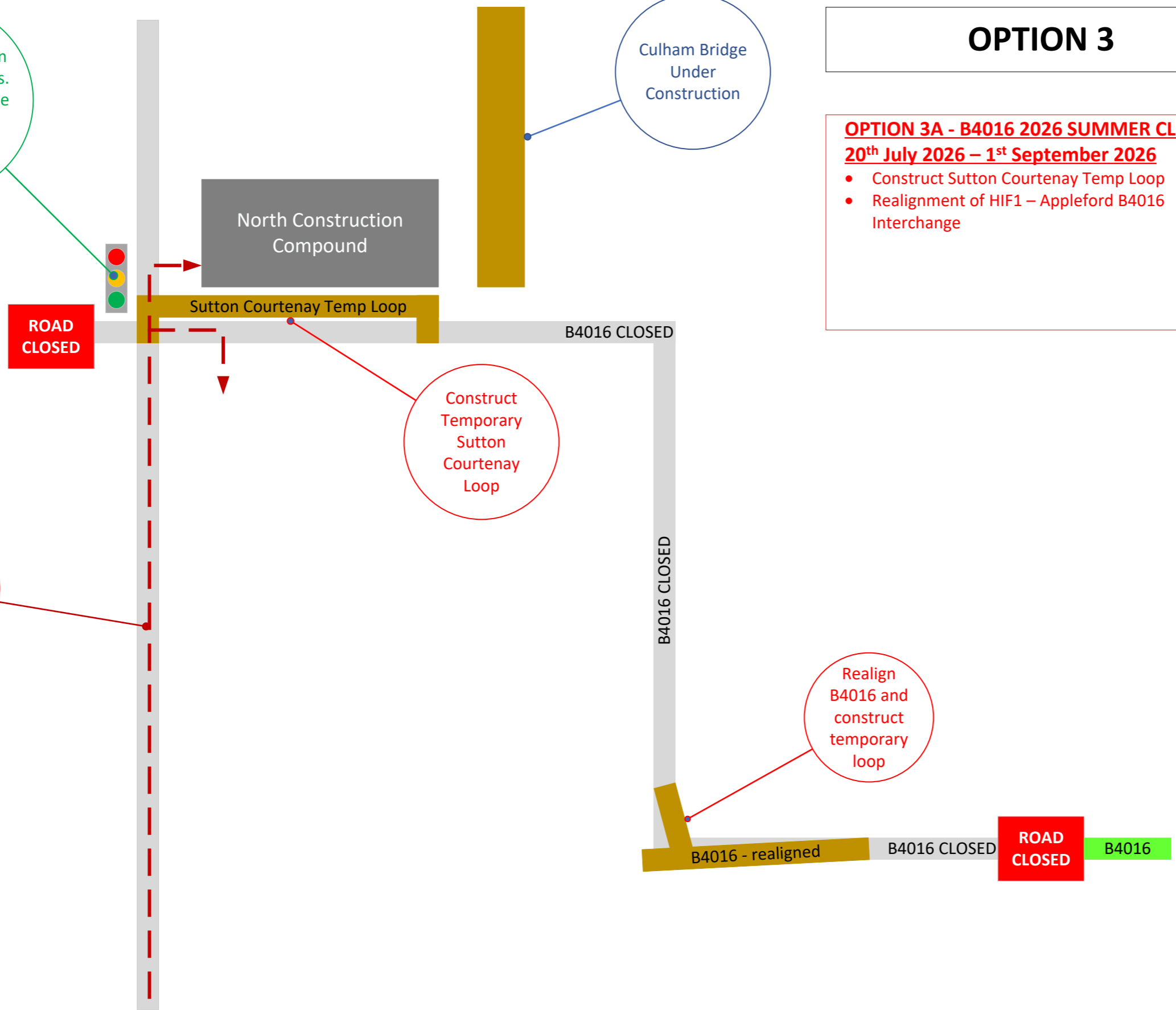

Datom Engineering Ltd

B4016 – CONSTRUCTION METHOD OPTIONS

Legend:
 Road Open to Traffic
 Road Under Construction
 Road Complete but not open to Traffic

Originator: RH

Date of Issue: 18/03/26

STAGE 3A
 SUMMER 2026 – ROAD CLOSURE – TEMP TRAFFIC LOOPS

R3.0138/21-OP-DATOM-007 P01

Traffic Signals to assist Construction Traffic Movements. Traffic Signals to be in place for the duration of the works

Culham Bridge Under Construction

OPTION 3

OPTION3B - B4016 OPENS – TEMP LOOPS COMPLETE
1st September 2026

- Sutton Courtenay Temp Loop Completed
- Appleford Temp Loop Completed
- B4016 OPEN UNTIL SUMMER 2027

Notes:
1.

Construction Traffic Movements via Hanson Way

NEW ROAD LAYOUT

NEW ROAD LAYOUT

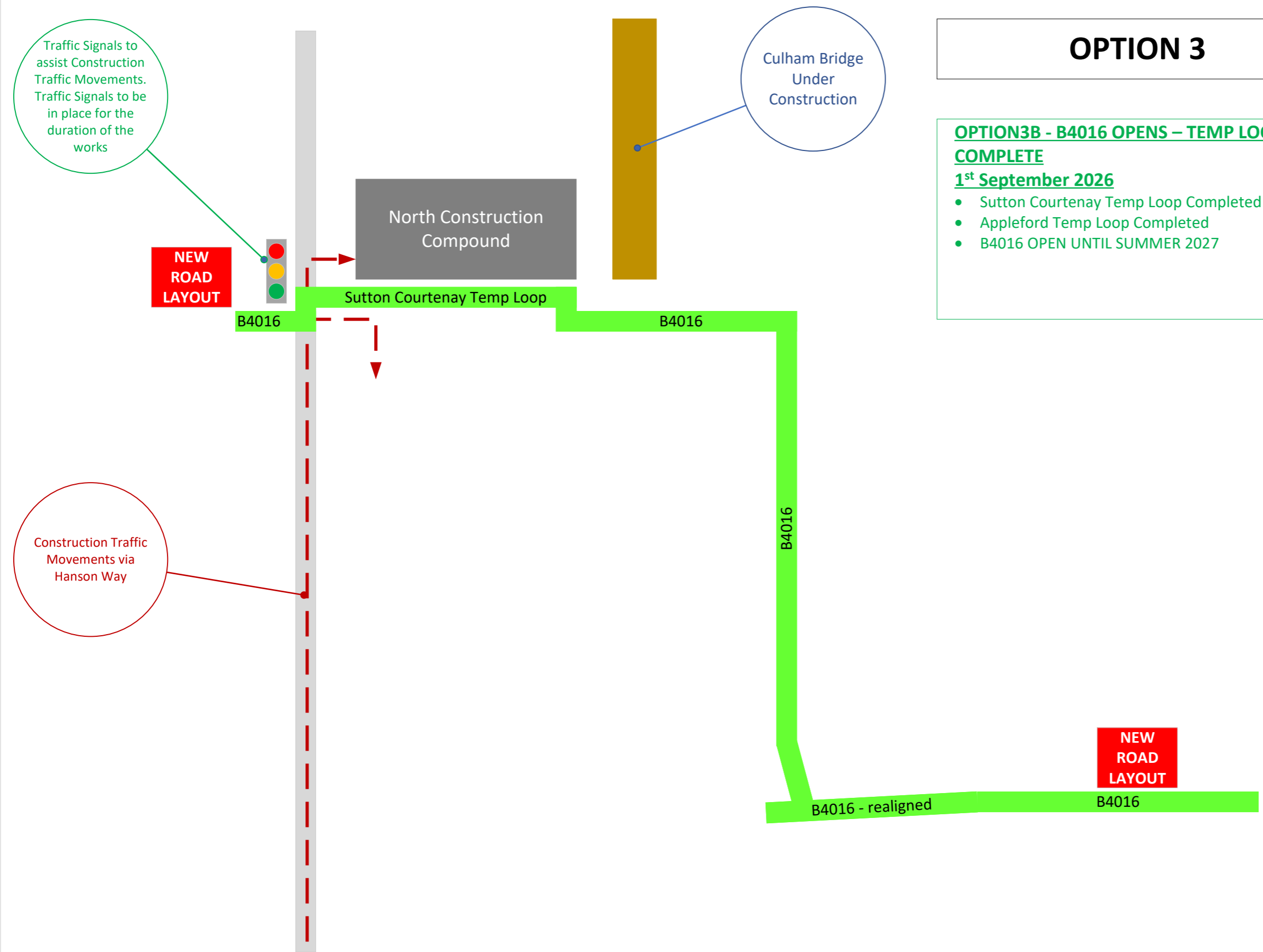

Legend:
 Road Open to Traffic
 Road Under Construction
 Road Complete but not open to Traffic

Originator: RH

Date of Issue:
18/03/26

STAGE 3B
END OF 2026 ROAD CLOSURE C/W TEMP LOOPS



B4016 – CONSTRUCTION METHOD OPTIONS

Traffic Signals to assist Construction Traffic Movements. Traffic Signals to be in place for the duration of the works

Culham Bridge Under Construction

OPTION 3

OPTION 3C – B4016 CLOSED 2027

B4016 ROAD CLOSED FROM START OF SUMMER SCHOOL HOLIDAY (CIRCA 19th JULY 2027 – 30th AUGUST 2027 FOR 6 WEEKS TO ALLOW THE CONTRACTOR TO MAKE THE FINAL CONNECTIONS TO THE EXISTING B4016 AT THE SUTTON COURTENAY END & APPLEFORD END.

Notes:

1.

Construction Traffic Movements via Hanson Way

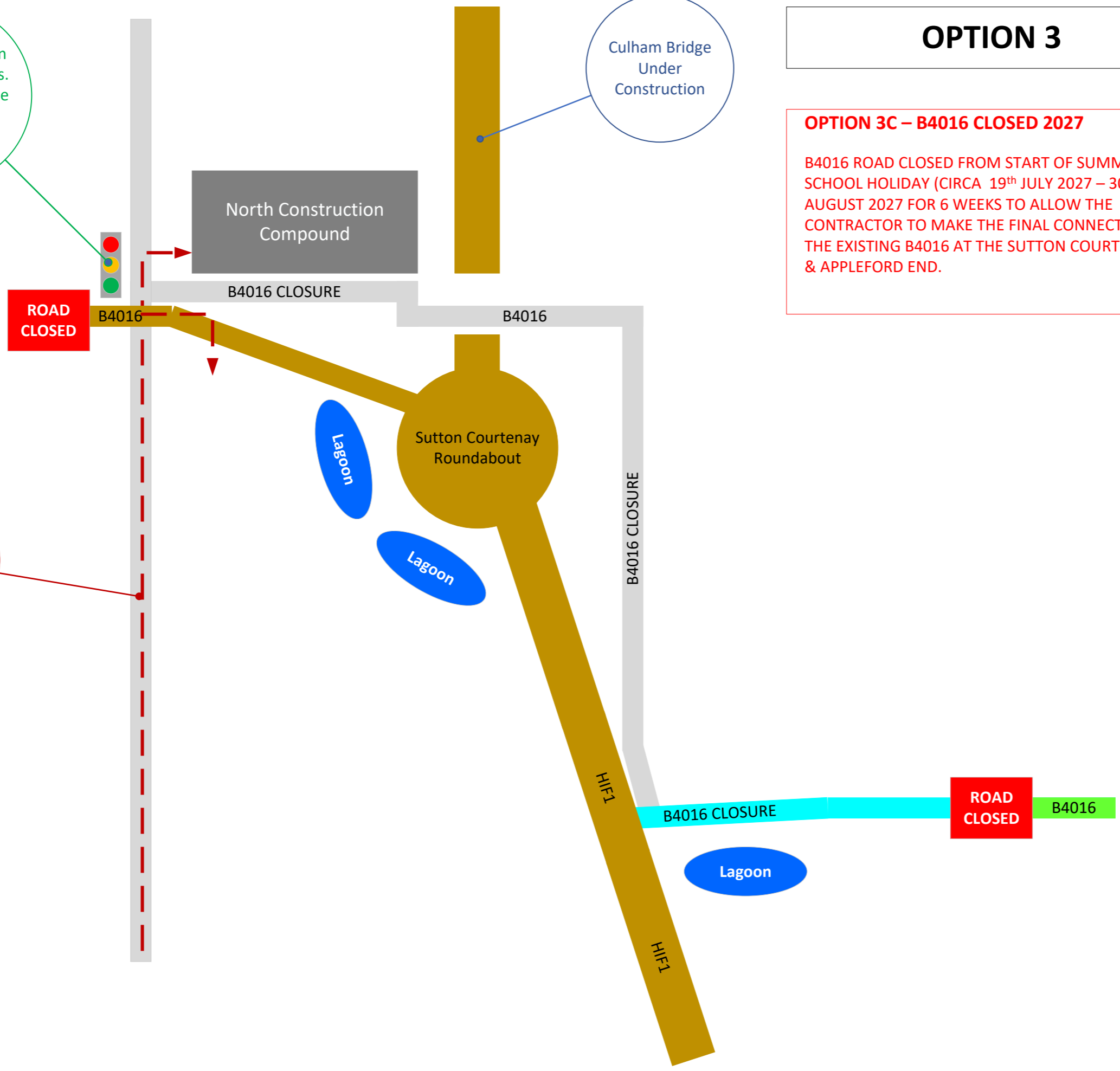

Legend:
 Road Open to Traffic
 Road Under Construction
 Road Complete but not open to Traffic

Originator: RH

Date of Issue: 18/03/26

OPTION 3C
B4016 CLOSURES SUMMER 2027

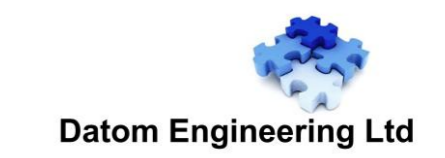

B4016 – CONSTRUCTION METHOD OPTIONS

Traffic Signals to assist Construction Traffic Movements. Traffic Signals to be in place for the duration of the works

Culham Bridge Under Construction

OPTION 3

OPTION 3D – B4016 OPENS 2027

FINAL B4016 NEW ROAD LAYOUT COMPLETED CIRCA AUGUST 2027

- RISK**
- LOW RISK OF CONSTRUCTION OVERRUN
 - ZERO IMPACT ON SCHOOLS
 - LOW IMPACT ON RESIDENTS
 - POSITIVE COMMUNITY ENGAGEMENT
 - REDUCED RISK DUE TO TRAFFIC MODELLING BEING INCORRECT
 - REDUCED RISK IMPACT DUE TO ANY A34 INCIDENT
 - LOW CONSTRUCTION RISKS
 - ADDITIONAL CONTRACTOR WORKS
 - ADDITIONAL COSTS FOR CLIENT
 - REDUCED CLIENT RISK ON WORKS COMPLETION
 - CLIENT CAN ANNOUNCE B4016 AHEAD OF SCHEDULE OF 2028 COMPLETION DATE
 - HIGH CLIENT QUDOS

Notes:
1.

Construction Traffic Movements via Hanson Way

NEW ROAD LAYOUT

NEW ROAD LAYOUT



Legend:
 Road Open to Traffic
 Road Under Construction
 Road Complete but not open to Traffic

Originator: RH

Date of Issue: 18/03/26

OPTION 3D
B4016 REOPENS EARLY AUGUST 2027



B4016 – CONSTRUCTION METHOD OPTIONS

Traffic Signals to assist Construction Traffic Movements. Traffic Signals to be in place for the duration of the works

Culham Bridge Under Construction

OPTION 4

OPTION 4A – 12 WEEK SUMMER/AUTUMN 2027 CLOSURE

B4016 ROAD CLOSED FROM START OF SUMMER SCHOOL HOLIDAY (19th JULY 27) FOR 12 WEEKS

Notes:

1.

Construction Traffic Movements via Hanson Way

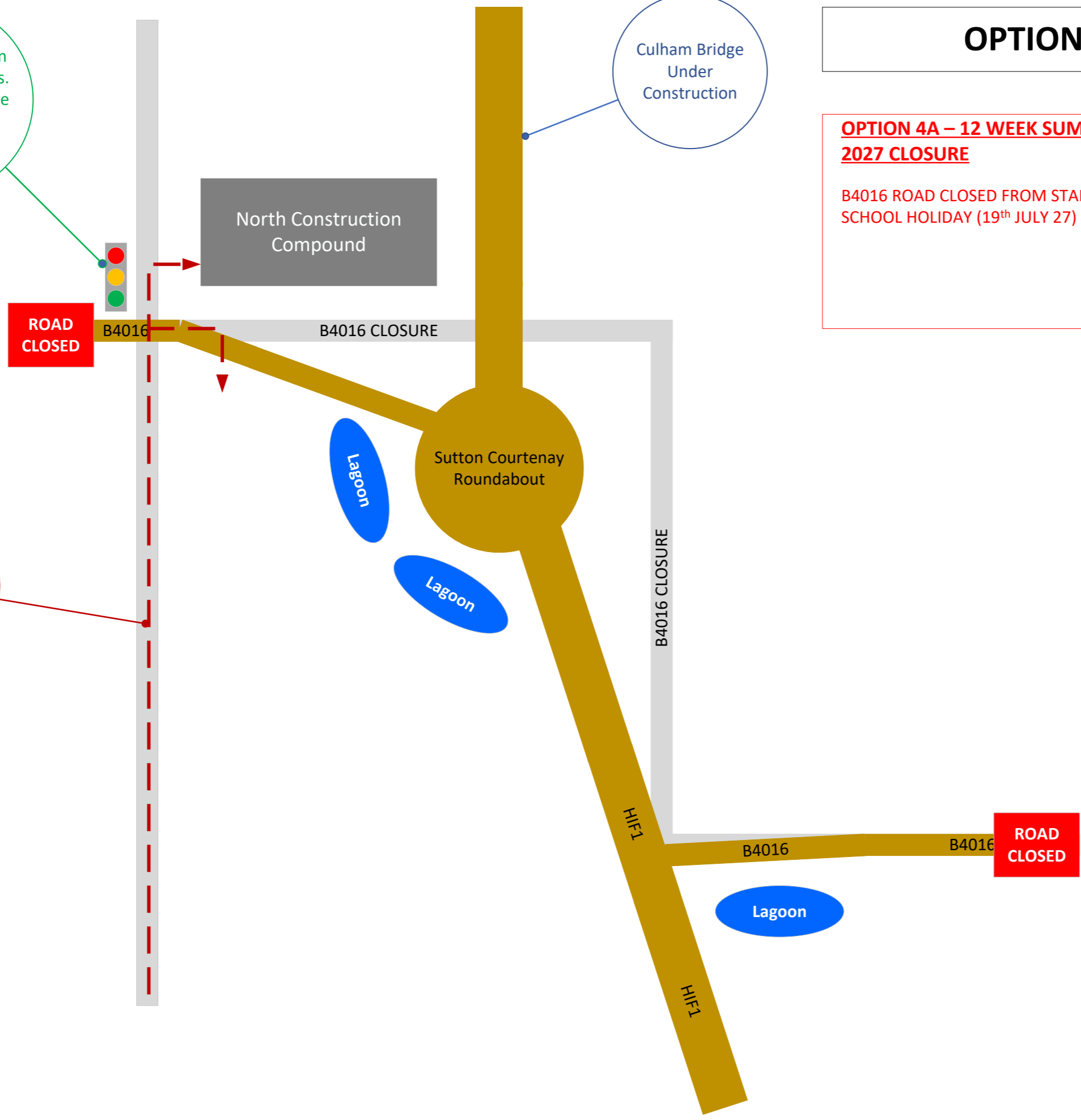

Legend:
 Road Open to Traffic
 Road Under Construction
 Road Complete but not open to Traffic

Originator: RH

Date of Issue: 18/03/26

OPTION 4A
 B4016 CLOSURES FOR 6 WEEKS SUMMER 2027



B4016 – CONSTRUCTION METHOD OPTIONS

Traffic Signals to assist Construction Traffic Movements. Traffic Signals to be in place for the duration of the works

Construction Traffic Movements via Hanson Way

NEW ROAD LAYOUT

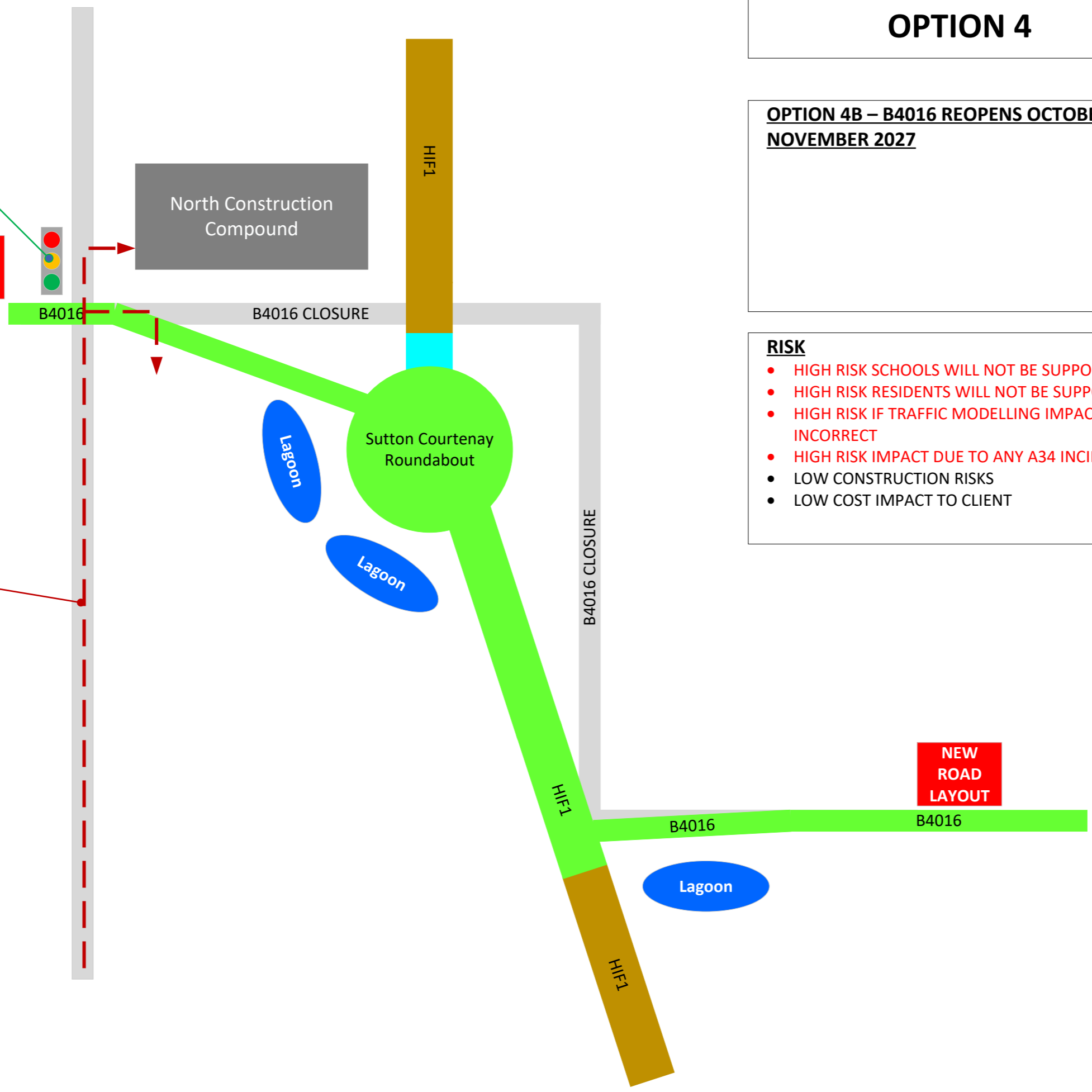

OPTION 4

OPTION 4B – B4016 REOPENS OCTOBER/ NOVEMBER 2027

- RISK**
- HIGH RISK SCHOOLS WILL NOT BE SUPPORTIVE
 - HIGH RISK RESIDENTS WILL NOT BE SUPPORTIVE
 - HIGH RISK IF TRAFFIC MODELLING IMPACT IS INCORRECT
 - HIGH RISK IMPACT DUE TO ANY A34 INCIDENT
 - LOW CONSTRUCTION RISKS
 - LOW COST IMPACT TO CLIENT

Notes:

1.



Datom Engineering Ltd

B4016 – CONSTRUCTION METHOD OPTIONS

Legend:
 Road Open to Traffic
 Road Under Construction
 Road Complete but not open to Traffic

Originator: RH

Date of Issue: 18/03/26

OPTION 4B
 B4016 OPENS OCTOBER/NOVEMBER 2027

R3.0138/21-OP-DATOM-012 P01

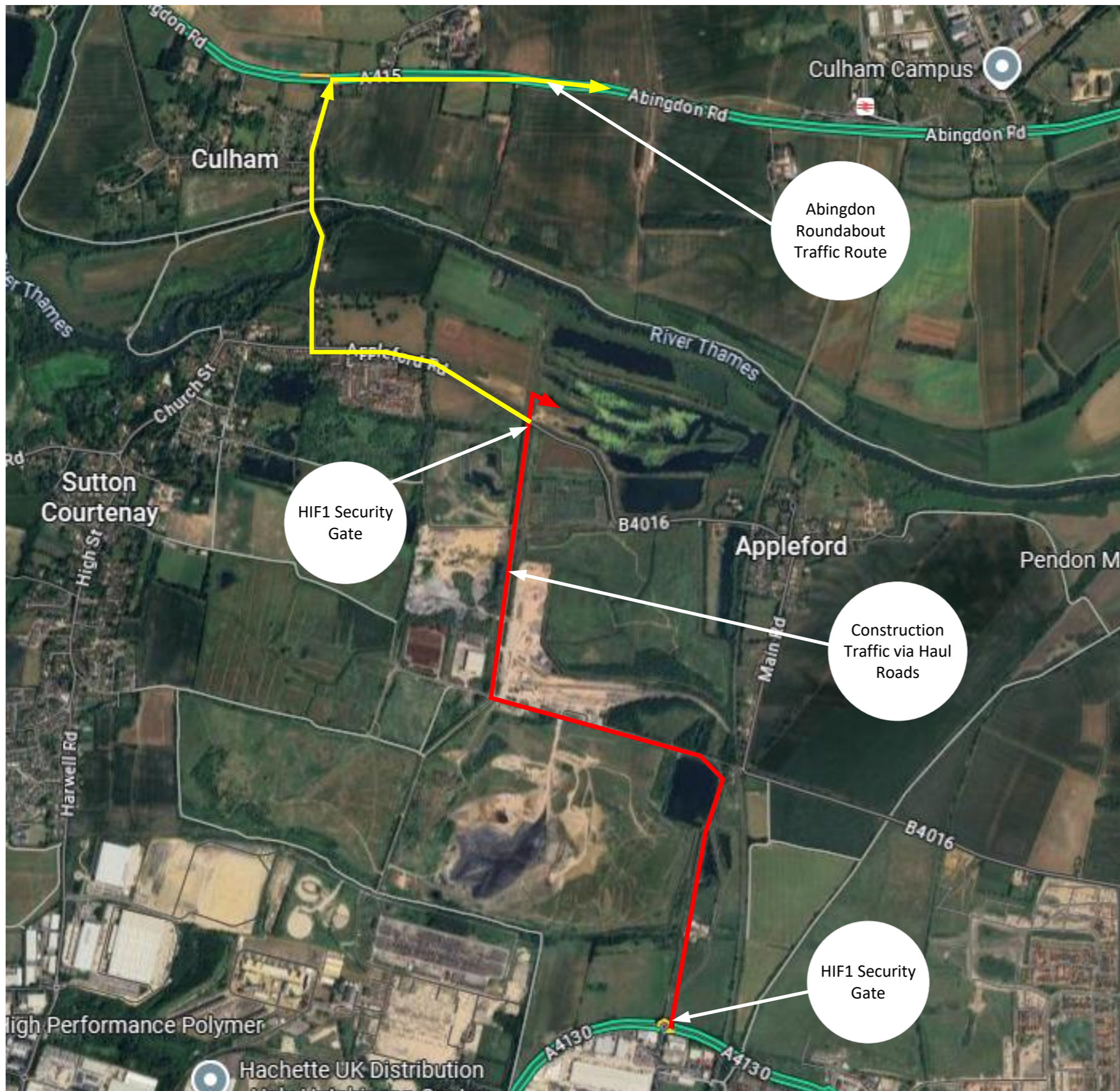

Notes:

- 1.



Datom Engineering Ltd

B4016 – CONSTRUCTION
METHOD OPTIONS

Legend:

Originator: RH

Date of Issue:
18/03/26

CTMP – CONSTRUCTION TRAFFIC ROUTE
VIA HAUL ROADS

R3.0138/21-OP-DATOM-013

P01